



**WARWICK**

BRUSSELS





WARWICK



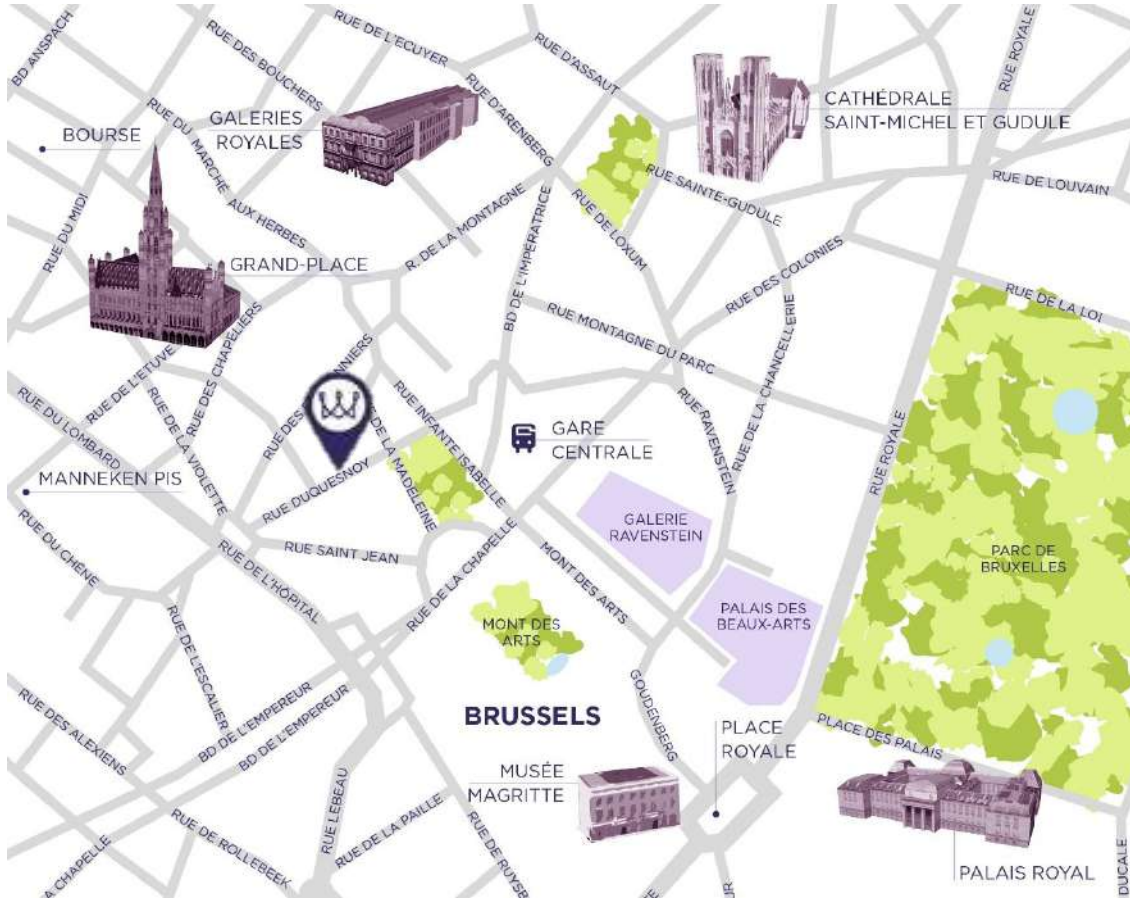

## Your meeting right in the centre of Brussels

- 👑 2 min walking distance from Central Station
- 👑 30 minutes by train from the Airport
- 👑 80 parking spaces
- 👑 5 min walking distance from the Square Congress Centre
- 👑 1 min walking distance from the famous Grand Place



# MEETING PACKAGES





## « Express » package

as from €79.00 pp

- **Morning coffee break**

Tea, coffee, orange juice, cereal bars, fruit basket and selection of 3 pastries

- **Sandwich buffet of the Chef**

- Soup of the day
- A selection of 3 salads
- 4 variety of sandwiches
- A salty pie
- 3 mini desserts
- Mineral water, tea and coffee

- **Afternoon coffee break**

Tea, coffee, fruit juices, sweets, fruit basket and a selection of 3 pastries

The Sandwich buffet of the Chef is served outside the meeting room as from 16 persons. Up to 15 persons, you have the possibility to continue your meeting with our

«Express Meeting Plate ».





## « Express » Vegan package as from €83.00 pp

- **Morning coffee break**

Tea, coffee, soy milk, orange juice, mango smoothie, vegan croissants, cereal bars and fruit basket.

- **Sandwich buffet of the Chef**

- Soup of the day
- A selection of 3 salads
- 4 variety of sandwiches
- 3 mini desserts
- Mineral water, tea and coffee

- **Afternoon coffee break**

Tea, coffee, soy milk, fruit juices, fruit salad, raspberry smoothie, vegetable dips and fruit basket.

The Sandwich buffet of the Chef is served outside the meeting room as from 16 persons. Up to 15 persons, you have the possibility to continue your meeting with our

«Express Meeting Plate »



## « Business » package as from €89.00 pp

- **Morning coffee break**

Tea, coffee, orange juice, cereal bars, fruit basket and selection of 3 pastries

- **Lunch of your choice**

- Buffet of the Chef (as from 20 persons) :

- Soup of the day
- A selection of 3 salads
- 2 hot dishes, meat and fish with 2 vegetarian side dishes
- 3 mini desserts
- Mineral water, tea and coffee

- 2 course lunch - Menu of the Chef (-20 persons):

«Starter + Main dish » or « Main dish + Dessert ».

Mineral water, tea and coffee included, served in our restaurant.

- **Afternoon coffee break**

Tea, coffee, fruit juices, sweets, fruit basket and a selection of 3 pastries





## « Prestige » package as from € 95.00 pp Minimum 20 persons

- **Morning coffee break**

Tea, coffee, orange juice, cereal bars, fruit basket and a selection of 3 pastries

- **3 course lunch - Menu of the Chef**

«Starter + Main dish + Dessert »  
mineral water, tea and coffee included

- **Afternoon coffee break**

Tea, coffee, fruit juices, sweets, fruit basket and a selection of 3 pastries





# Coffee Breaks

- Welcome Coffee Break:** €6.00 pp  
Tea, coffee, orange juice, mineral water
- Morning Coffee Break:** €9.00 pp  
Tea, coffee, orange juice, cereal bars, fruit basket, mineral water, selection of 3 pastries
- Vegan Morning Coffee Break:** €11.00 pp  
Tea, coffee, soy milk, orange juice, mango smoothie, vegan croissants, cereal bars and fruit basket.
- Afternoon Coffee Break:** €9.00 pp  
Tea, coffee, fruit juices, mineral water, sweets, fruit basket, selection of 3 pastries
- Vegan Afternoon coffee Break:** €11.00 pp  
Tea, coffee, soy milk, fruit juices, fruit salad, raspberry smoothie, vegetable dips and fruit basket.

# MEETING FACILITIES



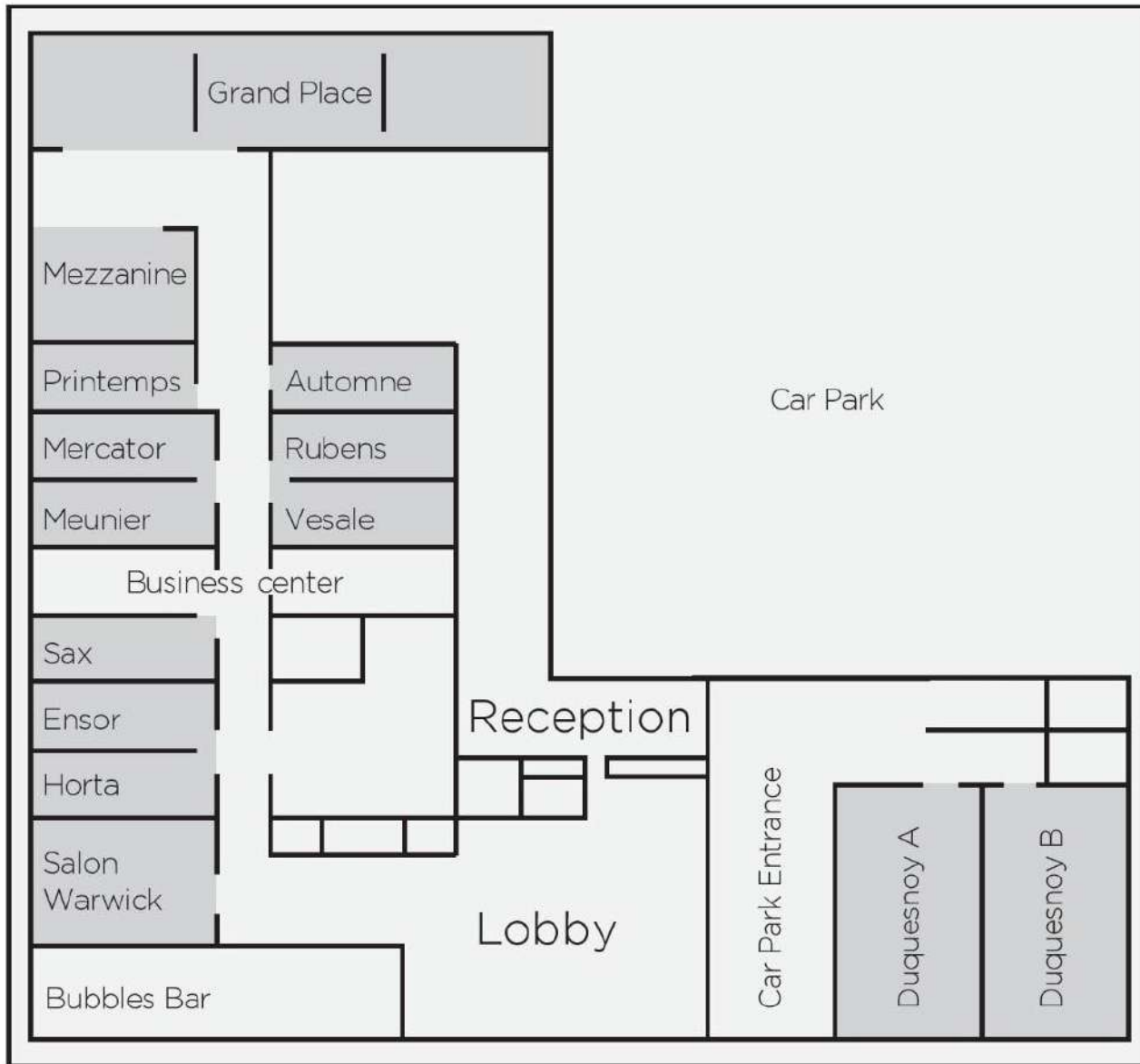

# Ground Floor



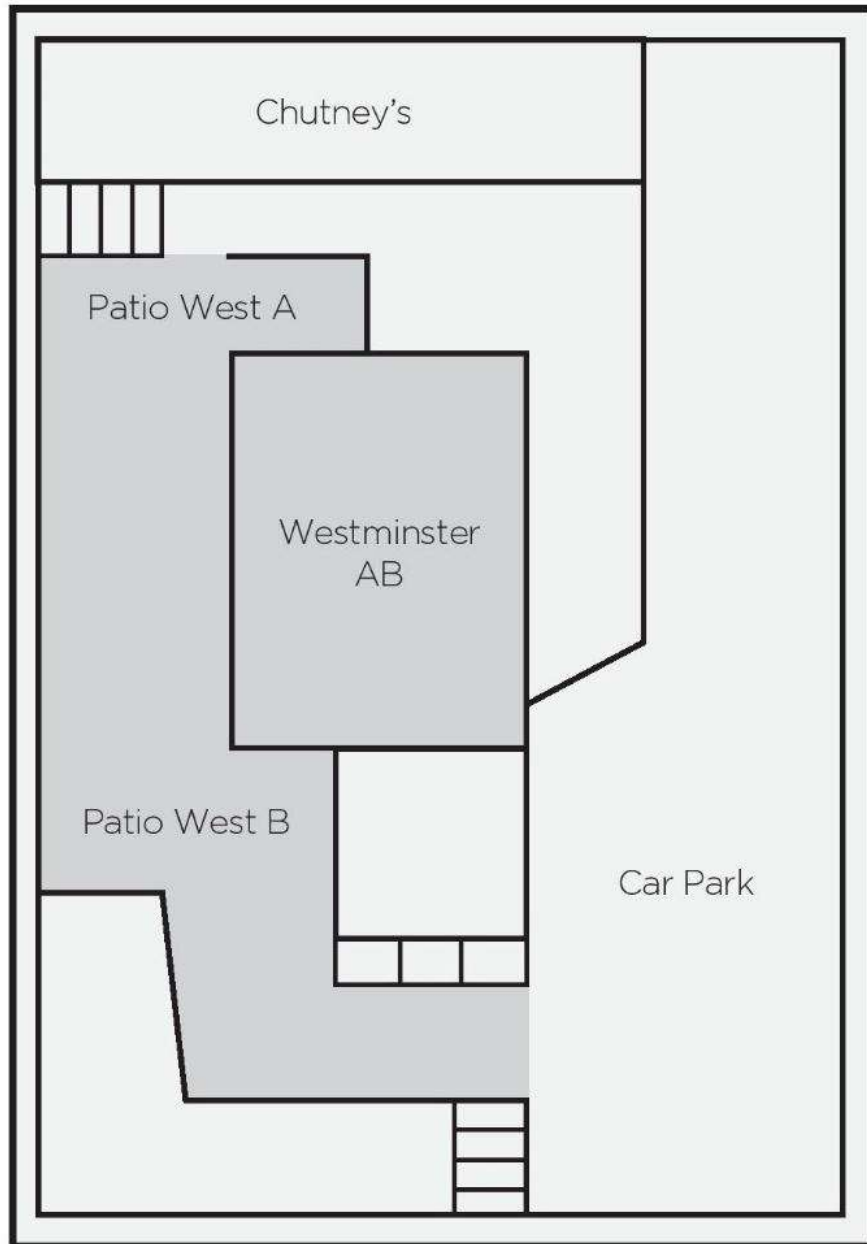

- 1 floor with daylight

Primary Function	Daylight	Room	Sqm / Sq ft	Dimensions U style (m)	School	Boardroom	Theatre	Banquet	Cocktails	Double U	Cabaret	
Exclusive Area	Yes	<b>Suite Grand Place</b>	400sqm including 120sqm Terrace		28	-	30	-	-	100	-	-
Catering area	Yes	<b>Salon Grand Place</b>			20	-	20	70	110	150	-	24
Meeting room	Yes	<b>Westminster A+B</b>	218sqm / 2,346.53 sq ft	17 x 13	60	100	57	200	156	250	100	126
Meeting room	Yes	<b>Westminster A</b>	126sqm / 1,356.25 sq ft	13 x 11	40	70	37	100	56	150	60	60
Meeting room	Yes	<b>Westminster B</b>	79sqm / 850.34 sq ft	13 x 6	35	70	32	80	35	100	55	30
Meeting room	Yes	<b>Duquesnoy A+B</b>	144sqm / 1,550 sq ft	12 x 12	39	88	34	130	90	100	60	90
Meeting room	Yes	<b>Duquesnoy A</b>	72 sqm / 775 sq ft	11 x 6	32	40	30	60	50	50	47	49
Meeting room	Yes	<b>Duquesnoy B</b>	72 sqm / 775 sq ft	12 x 6	32	40	30	60	50	50	47	49
Meeting room	Yes	<b>Warwick</b>	48sqm / 516.66 sq ft	7.5 x 6.5	23	24	20	38	32	45	25	24
Meeting room	Yes	<b>Horta</b>	20 sqm / 215.27 sq ft	5 x 4	-	12	13	18	-	-	-	-
Meeting room	Yes	<b>Ensor</b>	20 sqm / 215.27 sq ft	5 x 4	-	12	13	18	-	-	-	-
Meeting room	Yes	<b>Sax</b>	20 sqm / 215.27 sq ft	5 x 4	-	12	13	18	-	-	-	-
Meeting room	Yes	<b>Meunier</b>	20 sqm / 215.27 sq ft	5 x 4	-	12	13	18	-	-	-	-
Meeting room	Yes	<b>Mercator</b>	20 sqm / 215.27 sq ft	5 x 4	-	12	13	18	-	-	-	-
Meeting room	No	<b>Rubens</b>	20 sqm / 215.27 sq ft	5 x 4	-	12	13	18	-	-	-	-
Meeting room	No	<b>Vesale</b>	20 sqm / 215.27 sq ft	5 x 4	-	12	13	18	-	-	-	-
Meeting room	Yes	<b>Printemps</b>	20 sqm / 215.27 sq ft	5 x 4	-	12	13	18	-	-	-	-
Meeting room	No	<b>Automne</b>	20 sqm / 215.27 sq ft	5 x 4	-	12	13	18	-	-	-	-

# Capacity Chart With Physical Distance

Primary Function	Daylight	Room	Sqm / Sq ft	Maximum Capacity with physical distance	Full Day €	1/2Day €
Meeting room	Yes	<b>Westminster A+B</b>	218sqm / 2,346.53 sq ft	38	€2,000	€1,200
Meeting room	Yes	<b>Westminster A</b>	126sqm / 1,356.25 sq ft	24	€1,250	€750
Meeting room	Yes	<b>Westminster B</b>	79sqm / 850.34 sq ft	14	€800	€500
Meeting room	Yes	<b>Duquesnoy A+B</b>	144sqm / 1,550 sq ft	30	€1,400	€1,000
Meeting room	Yes	<b>Duquesnoy A</b>	72 sqm / 775 sq ft	14	€750	€500
Meeting room	Yes	<b>Duquesnoy B</b>	72 sqm / 775 sq ft	16	€750	€500
Meeting room	Yes	<b>Warwick</b>	48sqm / 516.66 sq ft	8	€650	€450
Meeting room	Yes	<b>Horta</b>	20 sqm / 215.27 sq ft	4	€300	€200
Meeting room	Yes	<b>Enzor</b>	20 sqm / 215.27 sq ft	4	€300	€200
Meeting room	Yes	<b>Sax</b>	20 sqm / 215.27 sq ft	4	€300	€200
Meeting room	Yes	<b>Meunier</b>	20 sqm / 215.27 sq ft	4	€300	€200
Meeting room	Yes	<b>Mercator</b>	20 sqm / 215.27 sq ft	4	€300	€200
Meeting room	No	<b>Rubens</b>	20 sqm / 215.27 sq ft	4	€250	€150
Meeting room	No	<b>Vesale</b>	20 sqm / 215.27 sq ft	4	€250	€150
Meeting room	Yes	<b>Printemps</b>	20 sqm / 215.27 sq ft	4	€300	€200
Meeting room	No	<b>Automne</b>	20 sqm / 215.27 sq ft	4	€250	€150





**Westminster A&B**





Duquesnoy A&B









**Executive Boardrooms**

MAKE IT UNIQUE







## The Grand Place Suite

The Grand Place Suite is one of those exceptional places that will not leave you indifferent.

As night falls, the 120 sqm terrace offers a breathtaking panoramic view of the city's rooftops, with the Grand Place shining brightly in the center.

The Grand Place Suite will embellish any kind of event: from private dining to confidential meetings, it will all be turned into an unforgettable unique experience.

Don't hesitate to send us your request, our dedicated team will put its great experience at your service to achieve your desires.



## The Grand Place Suite



400 sqm where the only limit is your imagination

# All our meeting proposals include:

- A Conference team dedicated to your event
- A meeting room adapted to the number of participants equipped with pens, note pads, sweets and mineral water on the table
- A beamer and its screen as well as a flipchart stay at your disposal
- Free Wi-Fi for your meeting

## Do you need more info ?

We'll be pleased to assist you on:

+32 2 505 57 13

[sales.warwickbrussels@warwickhotels.com](mailto:sales.warwickbrussels@warwickhotels.com)

